

PHILIPS

Lighting

Ledinaire Panel LED41S G5



Ledinaire Panel LED41S G5



Benefits

- An aesthetic and energy-saving replacement for classic raster fixtures
- Reliable quality, economical housing from the Philips brand
- Good quality and high effectiveness
- Quick and easy installation

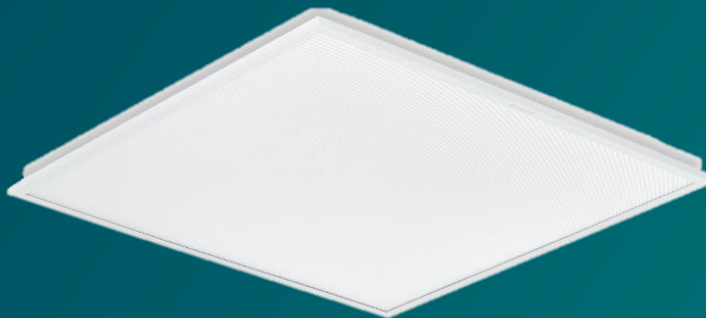

Features

- Luminous flux: 4 100 lm
- Efficacy: 120 lm/W
- Color temperature: 4 000 K
- CRI 80, SDCM <5
- High lifetime: 75 000h at L70 & 50 000h at L80
- 5-year warranty
- IP20/IP40
- Flywire connector – for quick installation
- Dimensions: 60 x 60 cm
- On/Off (PSU) driver
- NOC and OC versions available

Ledinaire Panel LED41S G5



Recessed – visible profile
ceilings



Plaster ceiling versions



Surface mounted version



Suspended version

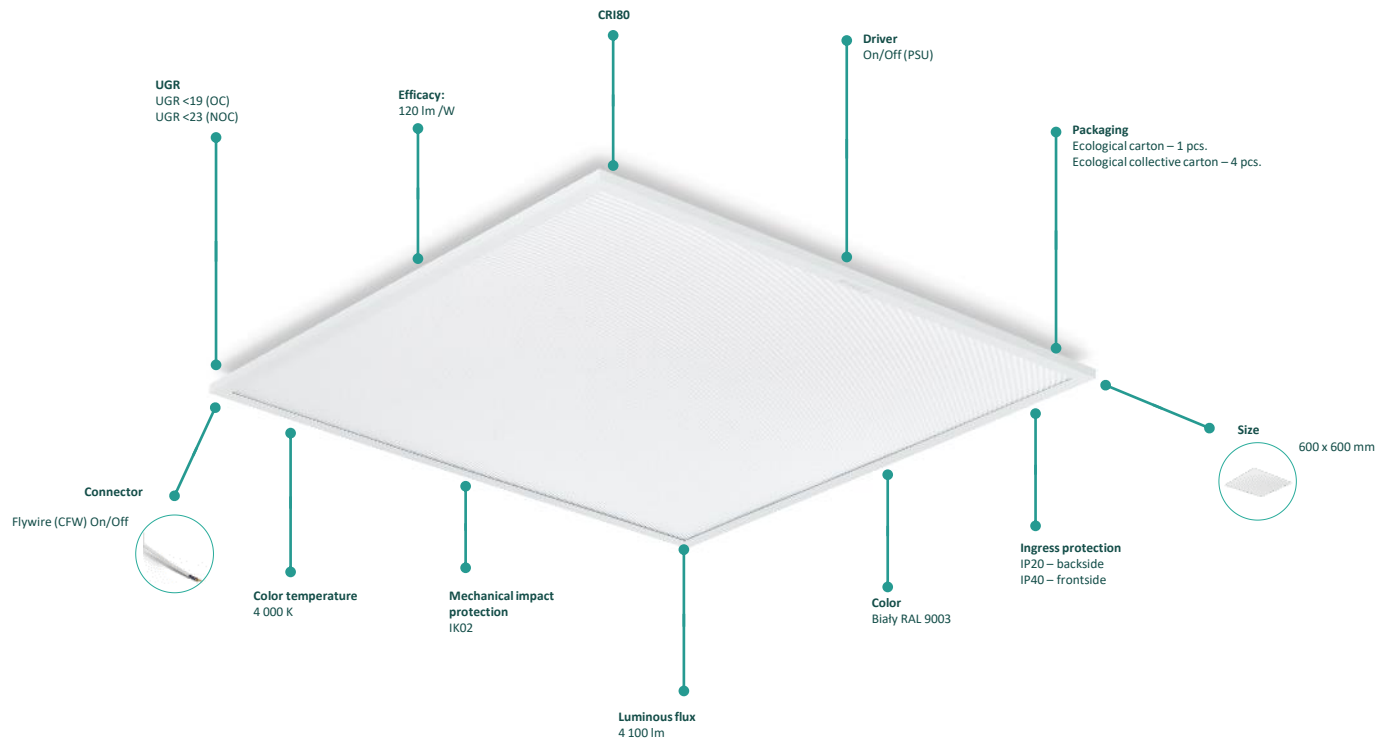

Ledinaire Panel LED41S G5 vs LED34S G4



- Increased efficiency from 100 lm/W to 120 lm/W
- Higher luminous flux – 4 100 lm
- Power – 34 W
- Lifetime: 75 000h at L75 and 50 000h at L80
- Flywire connection and no security cable
- Improved protection to IP20 backside and IP40 frontside
- Improved frame stiffness and robustness

	Philips Ledinaire G5	Philips Ledinaire G4
Efficacy	120 lm/W	100 lm/W
Luminous flux	4 100 lm	3 400 lm
UGR	UGR < 19 (OC) & <23 (NOC)	UGR < 19 & <23 (NOC)
SDCM	SDCM<5	SDCM<5
Lifetime 50 000h	L80	L80
Lifetime 75 000h	L70	L70
Color temperature	4 000 K	4 000 K
Lum. heigh	35 mm	36 mm
Size	600x600 mm	600x600 mm
IP	IP20 (backside) / IP40 (frontside)	IP20
Warranty	5 years	5 years

Ledinaire Panel G5; packaging, dimensions and connection



Ledinaire Panel LED41S G5 NOC CFW & OC CFW – PSU versions

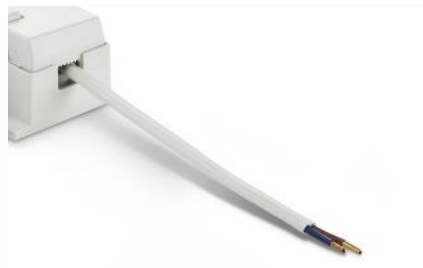
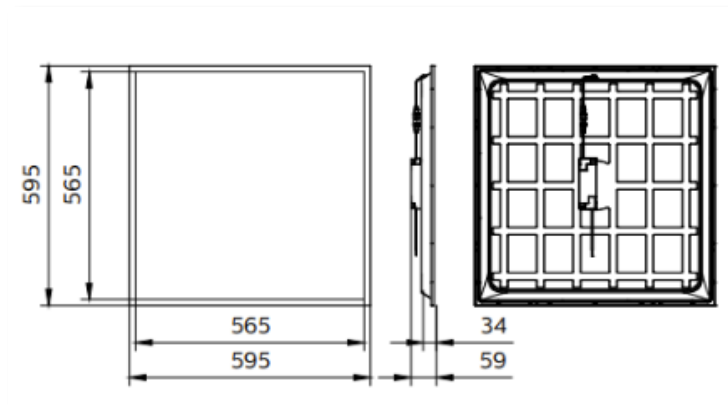
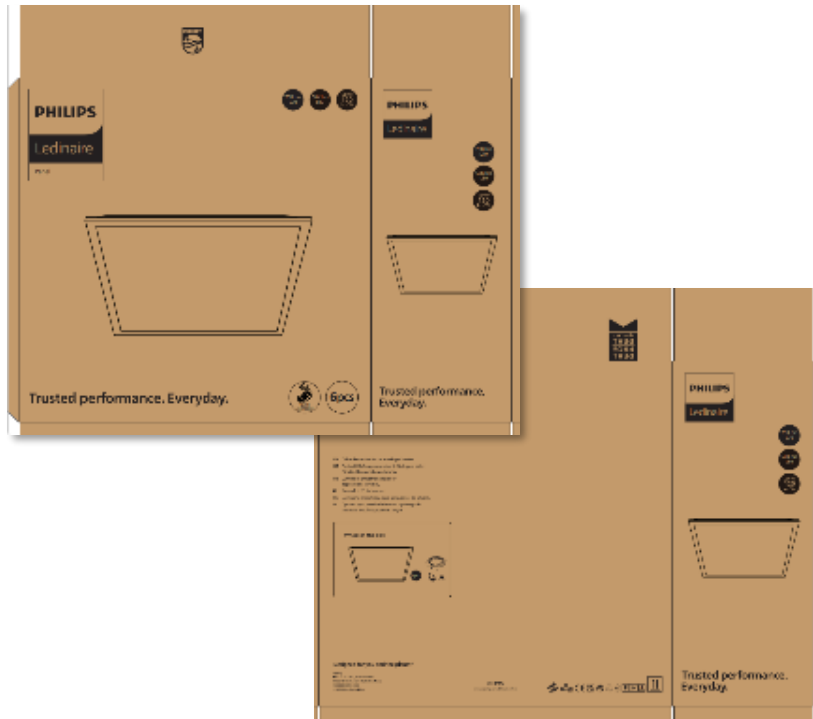

- PSU codes with flywire (CFW) connection
- No safety cable

Ledinaire Panel G5 – installation guideline

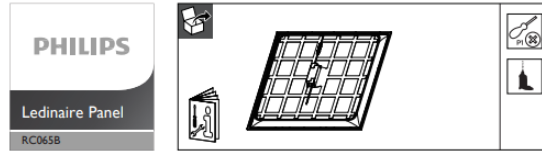

	Lumen (lm)	CCT (K)	P (W)	IP/KV	Energy efficiency of light source	L90/H4 (mm)	
RC065B GS 345x840 PSU VWSGL00 OC CFW	3400	4000	28.0	20/02	D	595x595x35	1.65
RC065B GS 345x840 PSU VWSGL00 OC CFW	3400	4000	28.0	20/02	D	595x595x35	1.65
RC065B GS 345x840 PSU VWSGL00 NOC CFW	3400	4000	28.0	20/02	D	595x595x34	1.35
RC065B GS 345x840 PSU VWSGL00 NOC CFW	3400	4000	28.0	20/02	D	595x595x34	1.35
RC065B GS 345x840 PSD VWSGL00 OC CFW	3400	4000	28.0	20/02	D	595x595x35	1.65
RC065B GS 345x840 PSD VWSGL00 OC CFW	3400	4000	28.0	20/02	D	595x595x34	1.35
RC065B GS 415x840 PSU VWSGL00 NOC CFW	4100	4000	34.0	20/02	D	595x595x35	1.65
RC065B GS 415x840 PSU VWSGL00 NOC CFW CL	4100	4000	34.0	20/02	D	595x595x34	1.35
RC065B GS 415x840 PSD VWSGL00 OC CFW CL	4100	4000	34.0	20/02	D	595x595x35	1.65
RC065B GS 415x840 PSD VWSGL00 NOC CFW CL	4100	4000	34.0	20/02	D	595x595x34	1.35
RC065B GS 345x840 PSU VWSGL00 OC CFW CL	3400	4000	28.0	20/02	D	595x595x35	1.65
RC065B GS 345x840 PSU VWSGL00 OC Tpa CFW	3400	4000	28.0	20/02	D	595x595x35	1.65
RC065B GS 605x840 PSU 60x120 NOC TPa CFW	6000	4000	50.0	20/02	D	1195x595x34	3.4

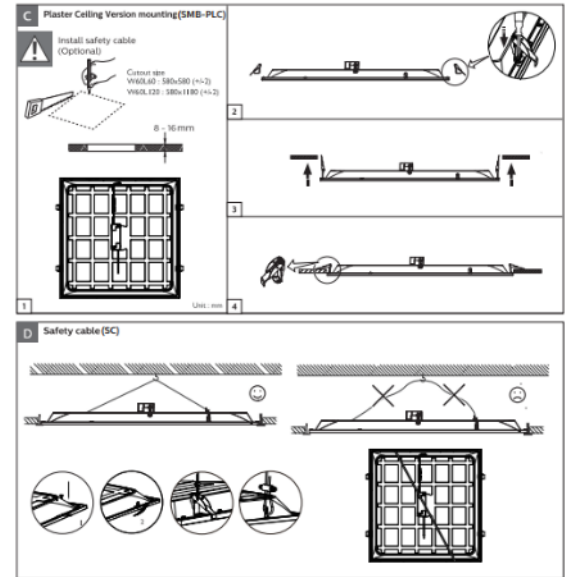
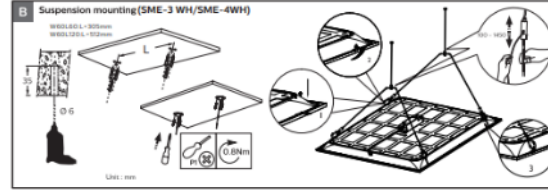
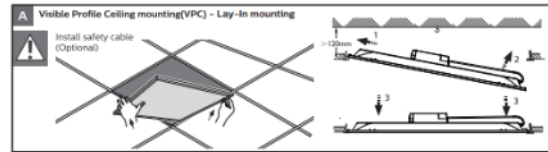
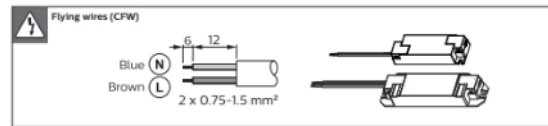
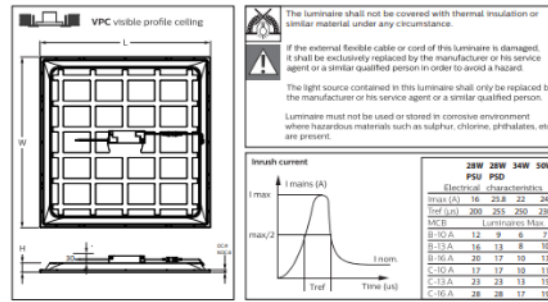
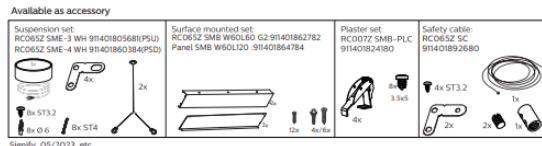
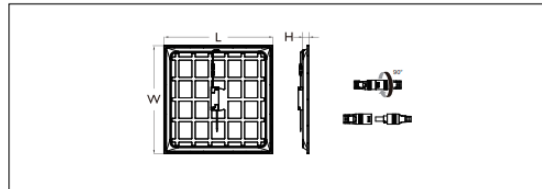

Philips and the Philips shield emblem are registered trademarks of Koninklijke Philips N.V.

Ledinaire Panel LED41S G5 & accessories



12NC	Product name	Link to e-catalog
911401875985	RC065B G5 41S/840 PSU W60L60 NOC CFW	RC065B G5 41S/840 PSU W60L60 NOC CFW 911401875985 Philips lighting
911401876085	RC065B G5 41S/840 PSU W60L60 OC CFW	RC065B G5 41S/840 PSU W60L60 OC CFW 911401876085 Philips lighting

Wszystkie kody akcesoriów pozostaną takie same jak w poprzedniej generacji

12NC	Accessory name	Link to e-catalog
911401892680	RC065Z SC	RC065Z SC 911401892680 Philips lighting
911401862782	RC065Z SMB W60L60 G2	RC065Z SMB W60L60 G2 911401862782 Philips lighting
911401805681	RC065Z SME-3 WH	RC065Z SME-3 WH 911401805681 Philips lighting
911401824180	RC007Z SMB-PLC	RC007Z SMB-PLC - Ledinaire Panel (signify.com)



Which G5 is replacing G4



Philips Ledinaire G5 Panel

12NC	Description
911401876085	RC065B G5 41S/840 PSU W60L60 OC CFW
911401875985	RC065B G5 41S/840 PSU W60L60 NOC CFW

is replacing:

is replacing:

Philips Ledinaire G4 Panel

12NC	Description
911401884580	RC065B LED34S/840 PSU W60L60 OC
911401820185	RC065B LED34S/840 PSU W60L60 OC BN
911401820285	RC065B LED34S/840 PSU W60L60 OC BN6
911401885080	RC065B LED34S/840 PSU W60L60 NOC
911401820385	RC065B LED34S/840 PSU W60L60 NOC BN
911401820485	RC065B LED34S/840 PSU W60L60 NOC BN6
911401823781	RC065B LED41S/840 PSU W60L60 NOC



© 2024 Signify Holding. All rights reserved. The information provided herein is subject to change, without notice. Signify does not give any representation or warranty as to the accuracy or completeness of the information included herein and shall not be liable for any action in reliance thereon. The information presented in this document is not intended as any commercial offer and does not form part of any quotation or contract, unless otherwise agreed by Signify.

Philips and the Philips Shield Emblem are registered trademarks of Koninklijke Philips N.V. All other trademarks are owned by Signify Holding or their respective owners.

lighting.philips.com